



FOCAL POINT

The Art of Architecture™

NICHE CAP INSTALLATION (1 of 2)

Installation Guide For Geneva Niche Cap 91001, 91002, 91003 (with casing) and Osborne Niche Cap 91004, 91005, 91006 (with pilasters)

Please Read And Follow All Installation Instructions Carefully

General

- Additional materials that need to be purchased:
 - 1/4" bending plywood
 - Wood for shell niche cap base and shelf
 - Framing material

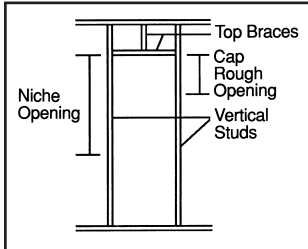
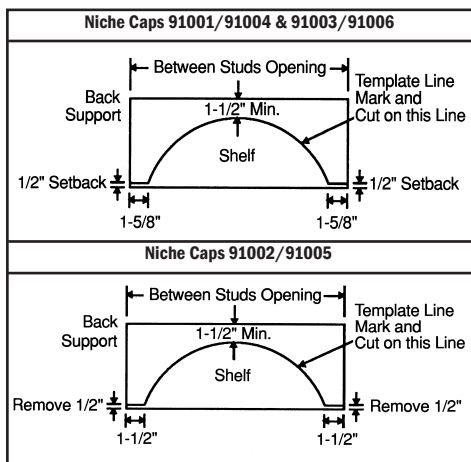

Figure 1



Figures 2 & 3

1. Framing Rough Opening

- Niches may require framing out from or into a new or existing wall.
- Top braces.
- Vertical studs. (figure 1)

2. Template for Framing and Bottom Base

- This template is used to build “back framing” (figures 2 & 3)
 - Top Back supports shell niche cap.
 - Bottom Back supports horizontal shelf inside the shell niche cap.
 - Center Back helps to support curved backing at top and bottom and any shelving desired (install 1” below shelf location).

3. Install Support Framing in Rough Opening

- Vertical front and back side braces.
- Bottom and top backs. (figure 4)

4. Cutting and Installing Curved Backing

- Use 1/4" bending plywood.
- Use shell niche cap as the template to determine width needed.
- Determine height needed, add 4" and cut to size.
- Position and nail into framing. (figure 5)

5. Installing Wooden Base

- Install vertical and horizontal bottom braces.
- Using the Shell Niche Cap as a template, cut wood to create base inside bottom of Niche Cap.
- Check level and nail base into bracing. (figure 5)

6. Wallboard Installation

- Install wallboard, leaving curved backing area open.
- Use Niche Cap as a template on wallboard, draw line and measure in 1/2" for the cutline and cut. (figure 6)

7. Niche Cap Installation

- Insert Niche Cap, resting it on the top back support, flush with wallboard.
- Groove on underside of Niche Cap fits over curved backing.
- Screw or nail Niche Cap into studs and braces. (figure 7)

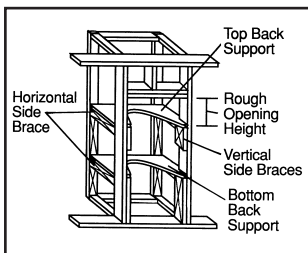

Figure 4

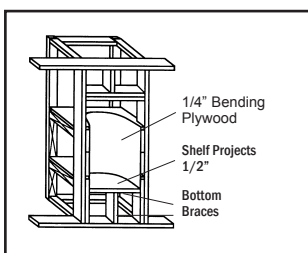

Figure 5

NICHE CAP INSTALLATION (2 of 2)

8. Shelf Bracket Installation

- Make Shelf Bracket from good quality cabinet wood: install as shown (*figure 8*).

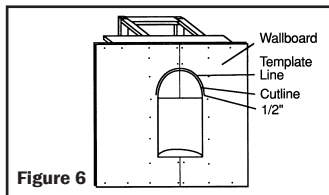

Figure 6

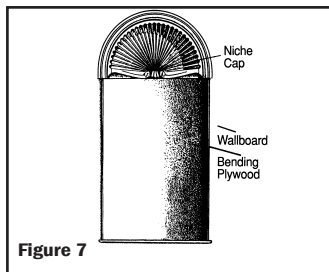

Figure 7

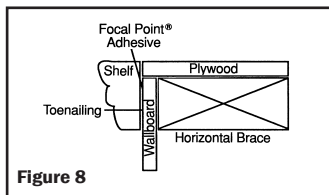

Figure 8

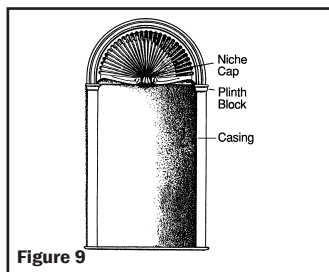

Figure 9

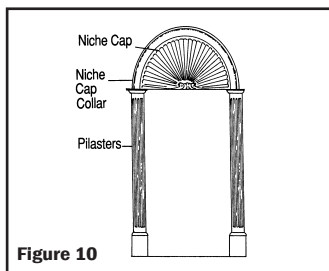

Figure 10

9. Installation of Trim Pieces

• If using Casing:

- Center separate plinth blocks along bottom side edges of the niche cap, screw or nail into place.
- Measure distance between plinths and shelf, cut casing to length for each side.
- Plumb/level casing, screw or nail into place. (*figure 9*)

• If using Fluted Pilasters

- **Do Not** use plinth blocks provided.
- Center and place Niche Cap Collar (arched piece or pieces) over top of niche cap casing; center, level and screw or nail into place. The bottom edges of the niche cap collar should be level with the bottom edge of the niche cap. Trim if necessary.
- Measure the distance between bottom of niche cap and shelf; trim bottom of pilasters if needed. Center the pilaster under the niche cap edge/niche cap collar; check plumb/level and screw or nail into place (*figure 10*).

10. Finishing

- Countersink all nails and screws, spackle, sand and prime.
- Paint with high quality latex or oil-based paint.
- **Do Not** use lacquer-based paints.

Niche Cap	91001 / 91004	91002 / 91005	91003 / 91006
Overall	Width A	42-1/2"	37-3/16"
	Depth B	17"	12"
	Height C	23-1/2"	18-1/4"
Inside	Width D	36"	28-3/4"
	Depth E	14-3/4"	10"
	Height F	20-1/4"	14-3/8"
Rough Opening	Width G	40"	34"
	Depth H	16-1/2"	11"
	Height I	22-1/4"	17-1/2"

